

# **SERIES 0251**

## **FOAM PAD CURTAIN TRUCK DOCK SEAL**

### **INSTALLATION INSTRUCTIONS**

READ ALL INSTRUCTIONS BEFORE INSTALLING SEAL. MANUFACTURER WILL NOT BE HELD RESPONSIBLE FOR IMPROPER INSTALLATION OF ANCHORING DEVICES, OR FOR INSTALLATION INTO AGED OR UNSOUND CONCRETE, CONCRETE BLOCK, OR OTHER WALL OR FLOOR MATERIAL WHICH MAY RESULT IN PREMATURE PRODUCT WEAR, PRODUCT FAILURE, PROPERTY DAMAGE, OR PERSONAL INJURY.

#### **1. Check Order**

- a. **Measure door opening height and width.** Make sure dimensions match the Purchase Order.
- b. **Check Parts List.** Make sure all parts have been supplied.

#### **2. Suggested Mounting Methods:**

- a. **CONCRETE BLOCK OR BRICK WALL:** Use 3/8" x 1-7/8" expansion anchors. Use through bolt fastening if anchors will not hold – 3/8" threaded rod is recommended (supplied by others).
- b. **PRECAST CONCRETE:** Same as above.
- c. **METAL SIDING BUILDING:** Through bolt fastening as above (supplied by others). Use a back up plate (steel or wood) to support bolts. Another alternative is to use wood lags with back plate from inside building to back of seal.

#### **3. Determine Centerline of Door Opening and Head Curtain:**

Locate centerline of door opening and mark on dock floor. Take 1/2 the head curtain width and mark this distance on both sides of the door centerline. This will determine the outside position of each vertical pad. This will also determine the location of the sleeve anchors for the head curtain.

#### **4. Attach Mounting Brackets to Vertical Pads:**

##### **Before starting please note:**

The taper cut signifies the top of the vertical pad and the bottom is signified by a taper cut with vent holes. Fasten three galvanized steel angle bracket, using No. 14 wood screws, to outside perimeter of each vertical pad. Fasten three galvanized steel flat brackets to the inside perimeter of each vertical pad using No. 14 wood screws (See Flat & Angle Bracket Mounting Detail).

**Note:** Final location of the brackets to be determined by the installer to suit spacing of the mortar joints or other wall configurations. Common location of brackets is one at center and one 12" from end.

#### **5. Position Vertical Pads:**

The bottom of the wood backing of the vertical pads should be even with the dock floor or at the top of "above dock bumpers" on low docks. Vertical pads must be plumb from top to bottom.

**Note:** Location of the vertical pads should be checked in order to ensure proper head curtain location. The outside dimension of the vertical pads must be the same as the width of the head curtain.

**6. Mount Vertical Pads to Wall:**

Once the vertical pad is in position, drive a 3/8" sleeve anchor bolt (Fig. 5) through the brackets. Once complete repeat for remaining vertical pad.

**7. Mount Head Curtain:**

Collect the head curtain with the attached flat bar and fasten it to the wall using 3/8" sleeve anchor bolts at the marked hole locations.

**Note:** There are marks at the hole locations of the steel curtain retaining bar, Begin at center and work out towards the end.

**8. Fasten Restraining Straps:**

On each side of the head curtain is a restraining strap. These straps must be mounted to the wood backing of the vertical pads using NO. 14 wood screws. (Detail "A")

**9. Caulk Between Top of Header Curtain and Wall:**

A silicone caulking is recommended.

**IMPORTANT**

- TRUCKS SHOULD NOT BE PERMITTED TO BACK INTO THE SEAL TO A DEPTH ANY GREATER THAN 3" TO GAIN MAXIMUM LIFE OF THE DOCK SEAL.
- VEHICLES MUST BACK UP PERPENDICULAR TO THE DOCK SEAL.

**PARTS LIST**

PART	QUANTITY
VERTICAL PAD	2
HEAD CURTAIN WITH FOAM PAD INSERT	1
GALVANIZED STEEL ANGLE MOUNTING BRACKETS	6
GALVANIZED STEEL FLAT MOUNTING BRACKETS	6
3/8" X 1-7/8" SLEEVE ANCHOR BOLTS	17
NO. 14 WOOD SCREWS Or 1/4" X 1 1/2" HEX WAHER TEK SCREW-ZINC (IF STEEL CHANNEL BACKING IS REQUIRED)	28

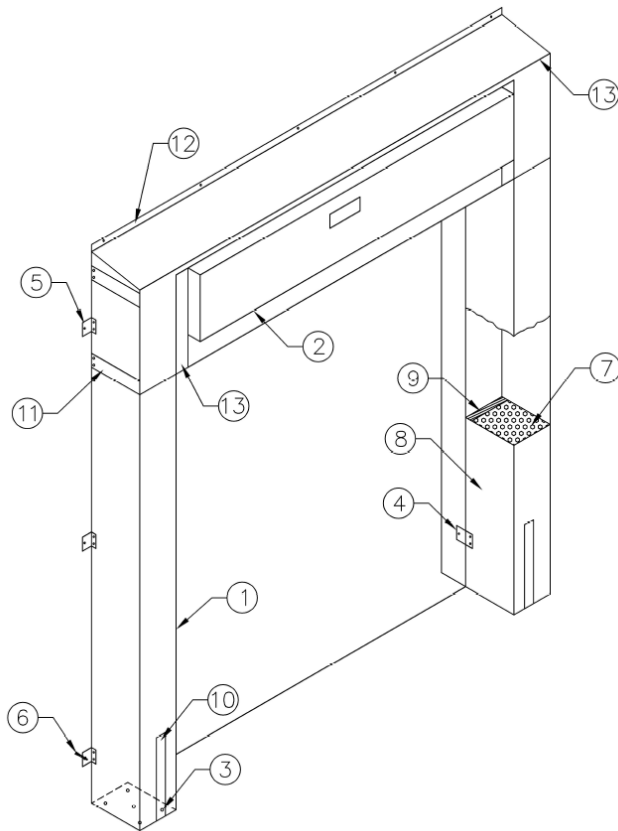

## BILL OF MATERIALS

1. VERTICAL PAD
2. HEAD CURTAIN WITH FOAM PAD INSERT
3. VENT HOLES
4. GALV. STEEL FLAT MOUNTING BRACKET
5. GALV. STEEL ANGLE MOUNTING BRACKET
6. 3/8" SLEEVE ANCHOR BOLTS.
7. POLYURETHANE FOAM CORE.
8. COVER FABRIC
9. WOOD BACKING
10. 4" WIDE YELLOW GUIDE STRIPE
11. RESTRAINING STRAP
12. STEEL CURTAIN RETAINING BAR
13. STEEL TUBE

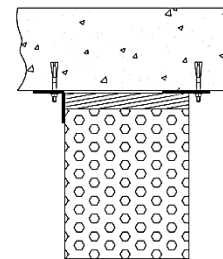

OFFSET MOUNTING

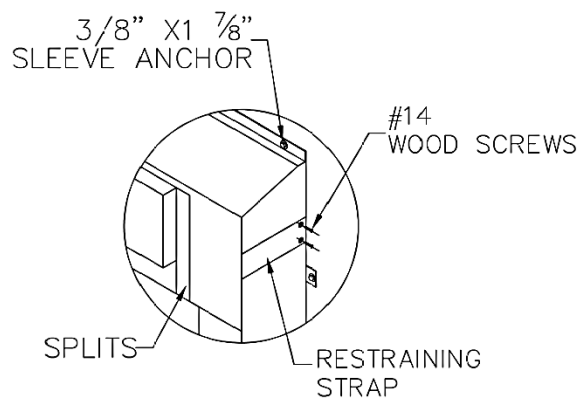

DETAIL "A"

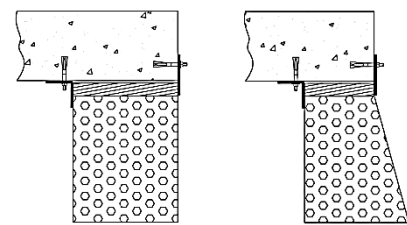

CUBED

WEDGED

FLAT & ANGLE BRACKET  
INSTALLATION

## FLAT & ANGLE BRACKET INSTALLATION